

# FOR SALE OR LEASE

## Royal Park Plaza Office Building

8050 W. Rifleman, Boise, ID

**PRICE:** \$2,300,000

### LEASING INFORMATION

	Size	Rate
Suite 100	+/-7,873 SF	<b>LEASED</b>
Suite 200	+/-2,044 SF	\$16.50 FSEJ*
Suite 300	+/-3,081 SF	<b>LEASED</b>
Total	+/-12,998 SF	

\*Full service excluding janitorial

TI Allowance Negotiable

### COMMENTS

- Class "A" construction
- Street and building signage
- Wired for data and communication
- High visibility location across from Pioneer Title
- High quality interior and improvements

**ZONING:** C2-D



**Located Near Boise Towne Square Mall**

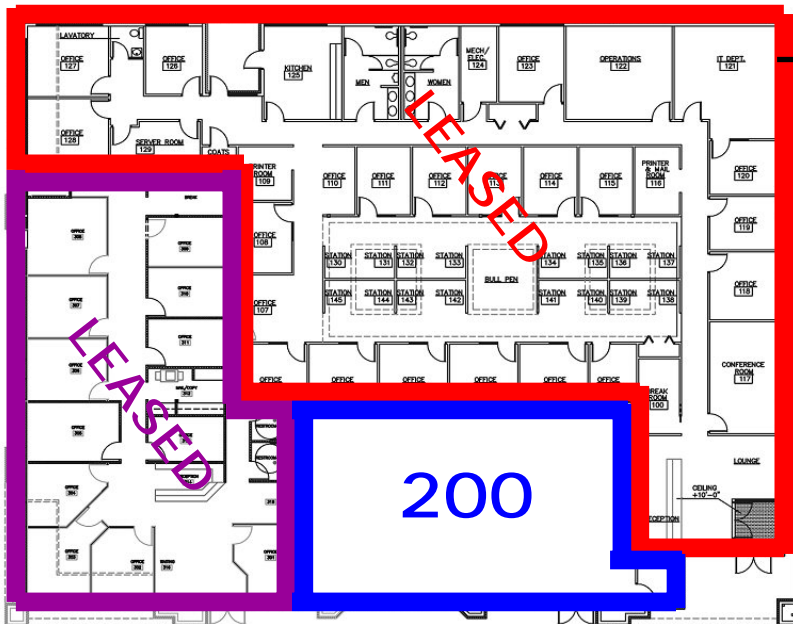
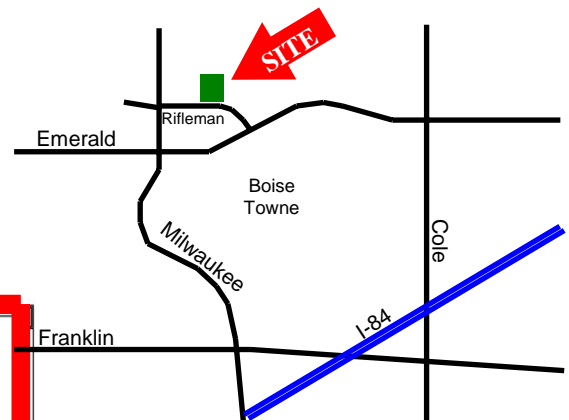

- Easy Access
- Great Visibility
- 5:1000 Parking

Rev 20081125

### ARTHUR BERRY & COMPANY

Commercial Real Estate Division

960 Broadway Avenue, Suite 450  
Boise, Idaho 83706  
Tel 208-336-8000 Fax 208-345-0609

For more information visit [www.arthurberry.com](http://www.arthurberry.com) or contact:

**RANDY LIMANI** 208-336-8000 Email: [rlimani@arthurberry.com](mailto:rlimani@arthurberry.com)

The information contained herein was obtained from sources deemed reliable. Arthur Berry & Company makes no representations or warranties, expressed or implied, as to the accuracy of the information. The information submitted is subject to errors, omissions and change of conditions. Buyer must verify the information and bear all risk for any inaccuracies. FILE 3684